



CRESTWOOD - CRAFTSMAN

\$608,950

**13305 W 179TH STREET OVERLAND PARK KS
66013**

<https://avitalhomeskc.com>

Welcome to "Crestwood," where comfort and style converge in this spacious 4-bedroom, 3.5-bath 2-story floorplan. Immerse yourself in the spacious primary bedroom suite, adorned with His and Hers walk-in closets for the ultimate in luxury. With a versatile Flex / Office space, a welcoming Entry Foyer opening to the Living, Dining, and Kitchen areas, "Crestwood" [...]

- 4 beds
- 3.5 baths
- Crestwood
- Two Story
- Wolf Run
- 2333 sq ft

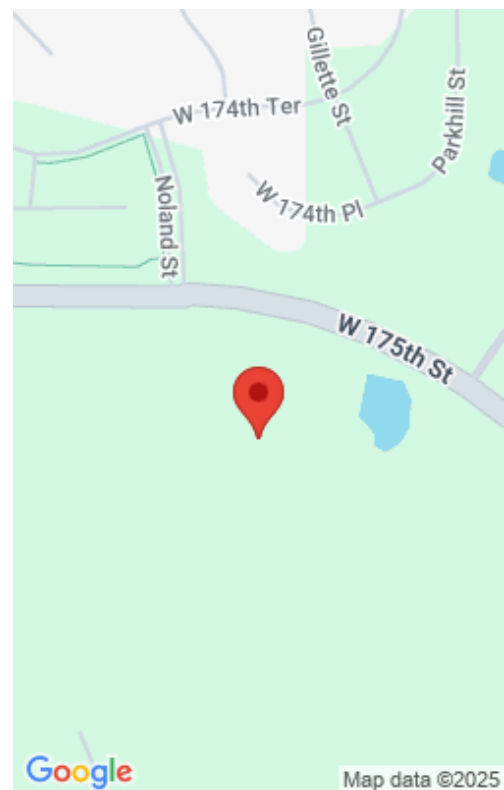

Basics

Status: Wolf Run
Bathrooms: 3.5 baths
Garage Spaces: 3
Community: Wolf Run
Lot: 79
Floorplan and Elevation: Crestwood - Craftsman

Bedrooms: 4 beds
Area, sq ft: 2333 sq ft
Basement: Unfinished
Type: Crestwood
Category: Two Story

Building Details

Basement: unfinished

